

Assembly instruction Bygghallen

Assembly instructions for the Bygghallen

1. Start by assembling the ground frame (8,8a and 9). Lock with lock pins (15). Assemble the end wall and long side, with 1 ring pin in each corner.
2. Install the roof trusses (1 and 2 with 13), lying on top of the ground frame. Lock the roof trusses with 1 ring pin (15) to the ground frame.
3. Raise the roof trusses. Lock with the 2:nd pin (15).
4. Install roof spacers (3) 52 pcs. and stay cables (10). Align legs with plumb line.
5. Measure and adjust the diagonal. Fix the ground with earth spikes (17). Lift the centre part of the ground frame out for the door.
6. Then install end wall posts (4a), door posts (4) and lintels (5).
7. Install end wall cloths (18 and 20), with 50 short end straps / end wall (25). Thread the tension tubes (21) into the tension pockets, install 2 long straps on each section and 9 straps round the door opening.
8. Adjust and tension the end wall cloths so that they hang correctly.
9. Roll out the roof cloth (19) on the long side of the hall. Thread 2 tension tubes (7) through the outer tension pockets in the cloth. Use 2 pull ropes about 30 m long, which are fixed to the tension tubes. Pull the cloth over. The ropes are not included.
NOTE! Help the cloth over, make sure it is not torn. Lift the cloth with a board etc. while it is being pulled over. Adjust the cloth correctly. The red marking shows the centre of the cloth. NOTE! Do not pull the cable in the roof cloth.
10. First tension the roof cloth with the existing cable. The cloth should fall 100-200 m over each end wall side (23). Lock the cable carefully with the rigging screw and cable clamps round the ground frame. Then install the tension tubes (7) in the tension tubes on the long sides. Then thread the tension cable in. Tension the roof cloth and lock with the rigging screws and cable clamps (22). NOTE! Lock the rigging screws securely.
11. Install the door blades (11) and bogie trucks (11b) in the door rail, lying on the ground. Raise the door and rail, install the lock tabs (6b) in the door posts and adjust to the correct height. Install the holders for the door rail (6a) and 2 long straps for adjusting the door. Install the door stops and adjust to give a suitable opening.
12. Every hall must be anchored with at least 1 earth spike (17) at every roof truss leg and end wall post, a total of 14 spikes. The earth spikes must be driven in obliquely (not straight down), please refer to the illustration for the earth spike. In exposed positions and on poor ground, you may be obliged to add more anchorage.

PROPRIETARY INFORMATION

This drawing/report/document contains proprietary information belonging to **HALBYGGARNA** and may not be wholly or partially reproduced nor disclosed without prior written permission of **HALBYGGARNA**

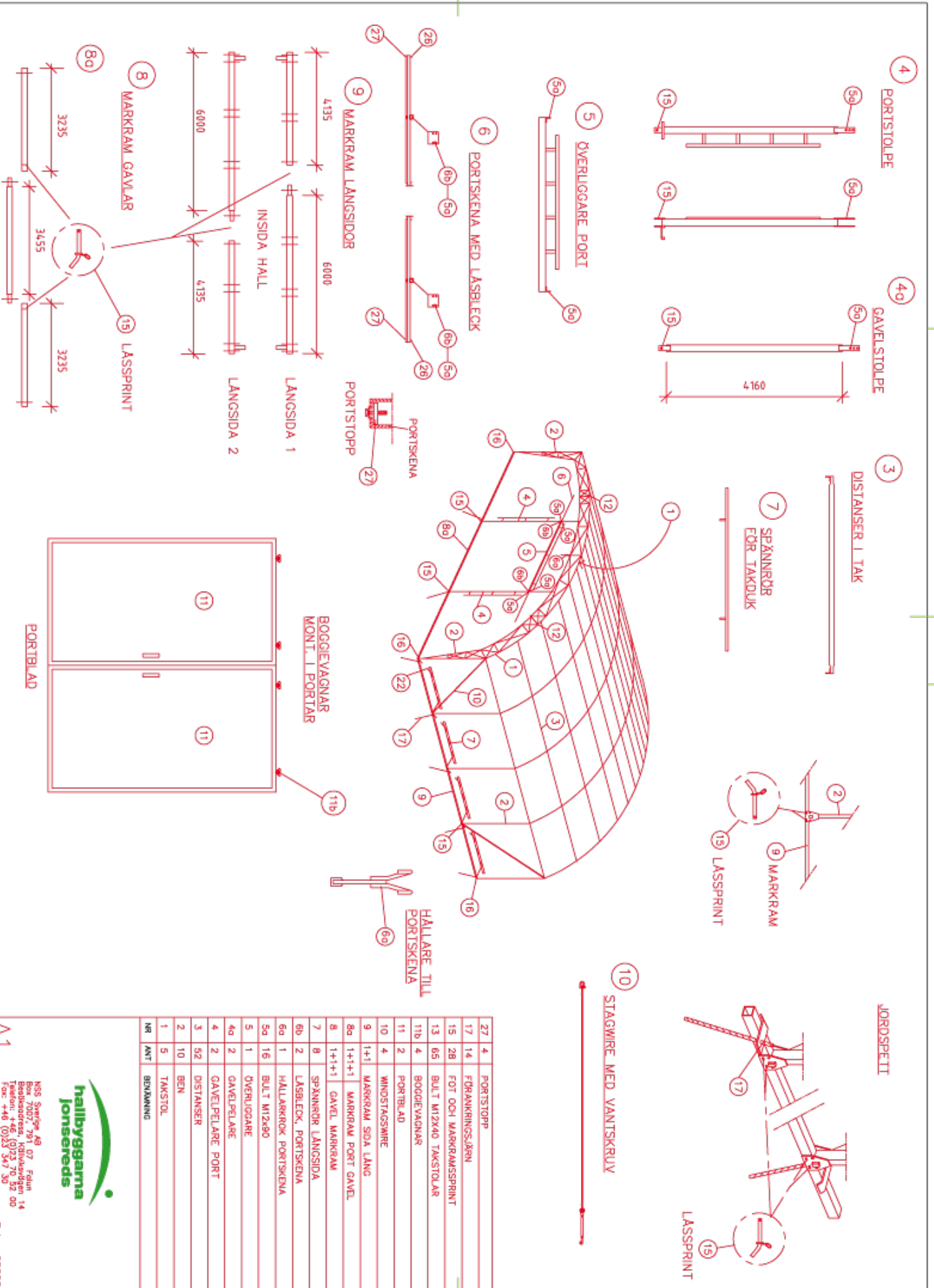

NR	ANT	BENÄMNING
27	4	PORTSTOPP
17	14	FÅHRANKNINGJÄRN
15	28	FOT OCH MARKRAMSSPRINT
13	65	BILT M2X40 TAKSTOLAR
11b	4	BOGGVAGNAR
11	2	PORTBLAD
10	4	WINDSTAGWIRE
9	1-1+1	MARKRAM SIDA LÅNG
8a	1-1+1+1	MARKRAM PORT GAVEL
8	1-1+1+1	GAVEL MARKRAM
7	8	SPÄNNRODR LÅNGSIDA
6b	2	LASBLECK, PORTSKENA
6a	1	HALLÄRRÖR, PORTSKENA
5a	16	BILT M12X90
5	1	ÖVERLIGGARE
4a	2	GAVELPELARE
4	2	GAVELPELARE PORT
3	52	DISTANSER
2	10	BEN
1	5	TAKSTOL
1	5	TAKSTOL

PROPRIETARY INFORMATION

This drawing/report/document contains proprietary information belonging to **HALBYGGARNA** and may not be wholly or partially reproduced nor disclosed without prior written permission of **HALBYGGARNA**

18 GAVELDUK MED PORT

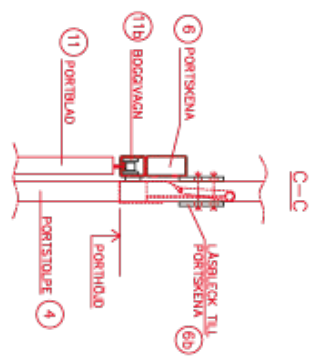
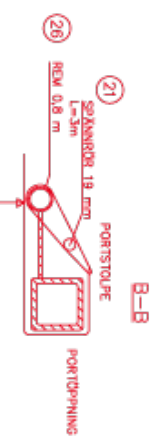
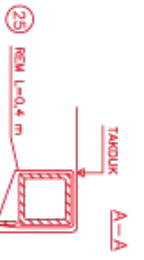
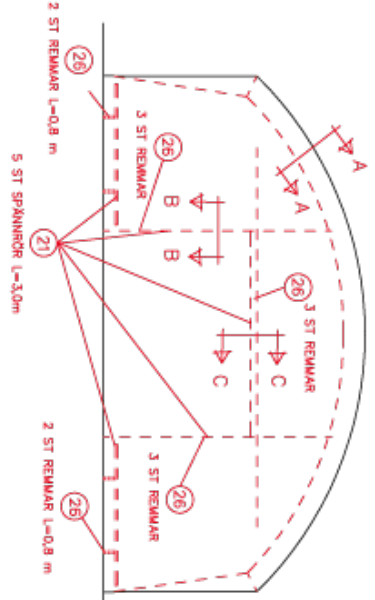

19 ÖVERDRAGNING AV DUK

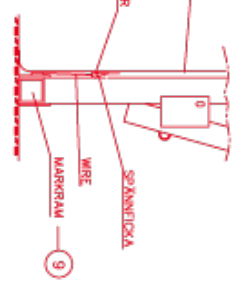
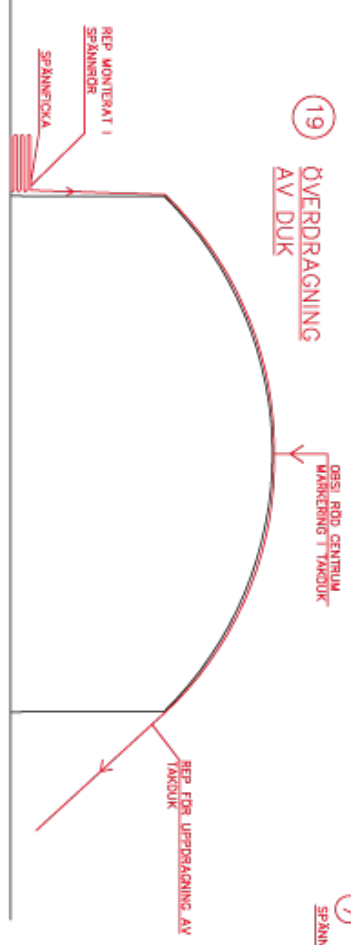

19 ÖVERDRAGNING AV DUK

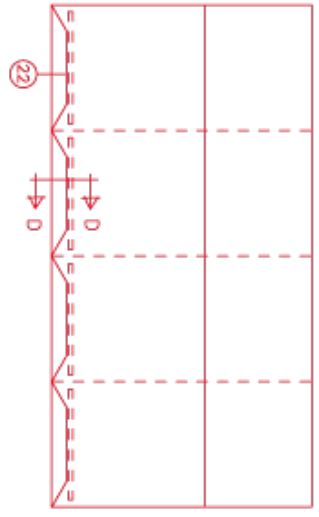

TAKDUK LÄGS UT EFTER ENA LÄNGSIDAN

20 GAVELDUK UTAN PORT

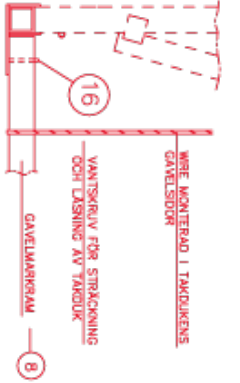
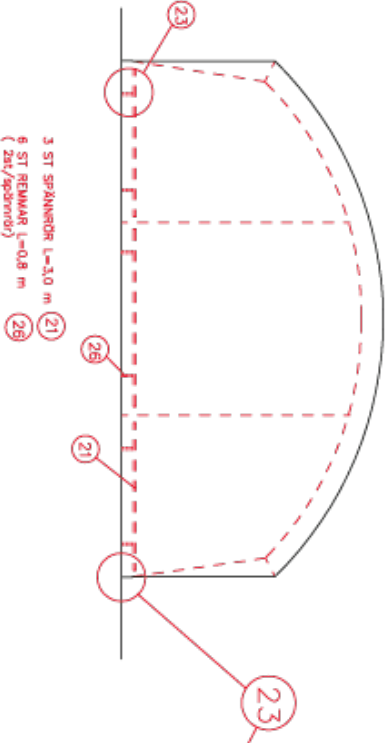

26	21	REMMAR L=0,8 m FÖR INSPÄNNING GAVEL
25	50	REMMAR L=0,4m UPPHÄNGNING AV GAVELDUK
23	4	VANTSKRUV FÖR LÄSNING AV TAKDUK
22	2	DUKSPÄNNWIRE L=11m
21	8	#19 mm SPÄNNRÖR GAVLAR + PORT L=3m
19	1	TAKDUK MED MONTERAD WIRE
20	1	GAVELDUK UTAN PORT
18	1	GAVELDUK MED PORTSPÄNNING
16	4	O-RINGSPRINT
NR	ANT	BENÄMNING



NSS Svanse 48
Box 7007, 791 07 Fålan
Bredåkersöarna, Östlångsödden 14
Tel: +46 (0)23 541 70 00
Fax: +46 (0)23 541 70 20

A2

Fålan 050629

