

Assembly instructions

System Gibson

Contents

System Gibson 10-22 _____	4
Attaching the Tarpaulin _____	6
Mounting of Frame Supports _____	6
Mounting of Frame Braces _____	7
Travel Beam _____	8
Tensioning the Tarpaulin _____	8
Attaching the Wall Tarpaulin _____	9
Tensioning the Wall Tarpaulin _____	9
Mounting of End Supports _____	10
Attaching the End Tarpaulin _____	10
Assembly of Entryway Leaves with Tarpaulin _____	11
Lift Points for 5 m Sections _____	12
Using Gibson on Scaffolding _____	12
Calculations _____	13
Dimensions _____	14
Component Designations _____	15
Tips and Advice _____	20
General Care Instructions _____	20



System Gibson 10-22

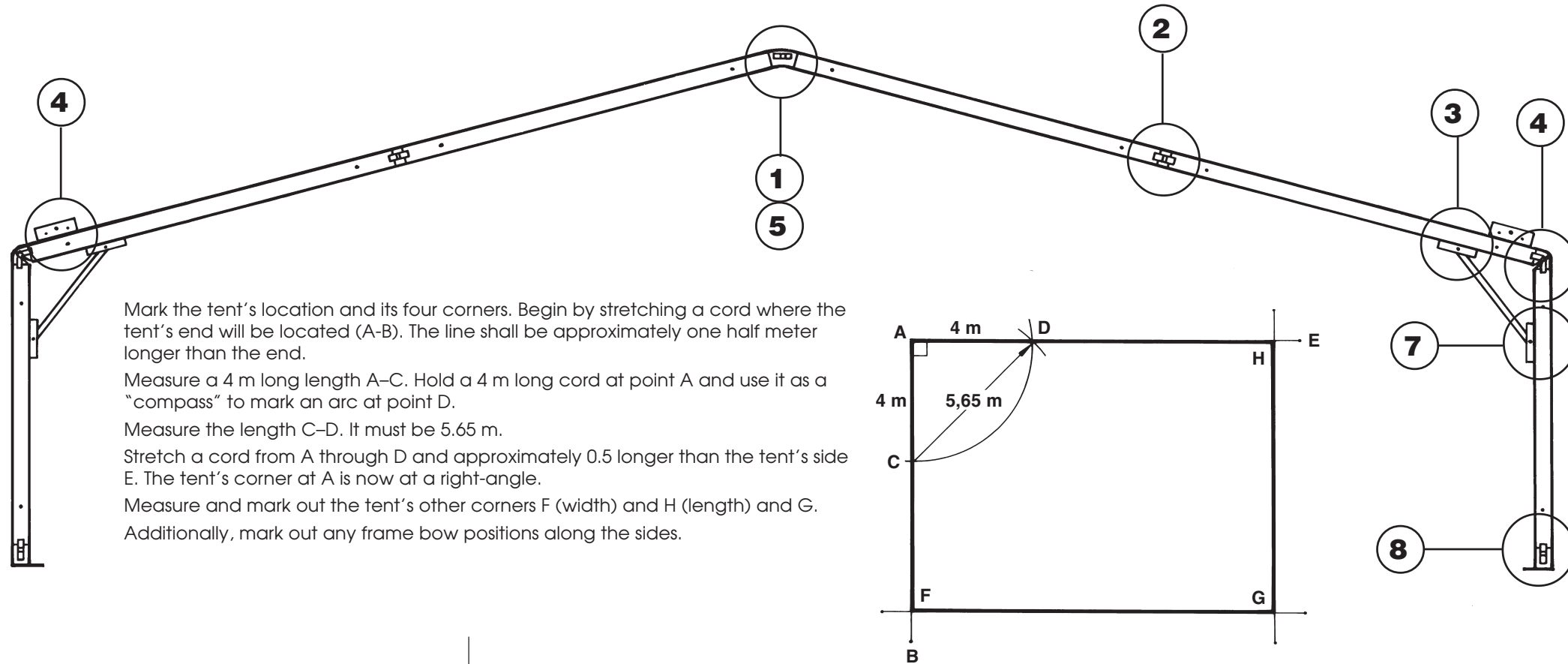

Mark the tent's location and its four corners. Begin by stretching a cord where the tent's end will be located (A-B). The line shall be approximately one half meter longer than the end.

Measure a 4 m long length A-C. Hold a 4 m long cord at point A and use it as a "compass" to mark an arc at point D.

Measure the length C-D. It must be 5.65 m.

Stretch a cord from A through D and approximately 0.5 longer than the tent's side E. The tent's corner at A is now at a right-angle.

Measure and mark out the tent's other corners F (width) and H (length) and G. Additionally, mark out any frame bow positions along the sides.

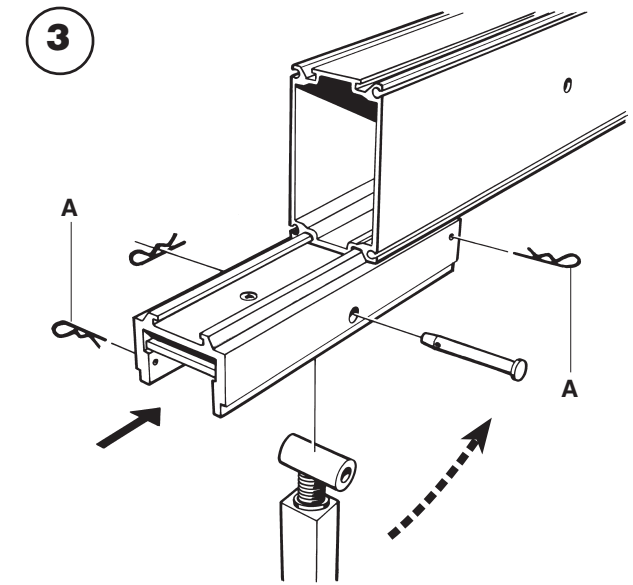

3. Push in the corner rod fitting (travel carrier) into the main beam to approximately 50 cm from the beam's end so that the studs on the fitting fit the holes in the beam. Secure the travel carrier with the hairpin springs (A).

Mount the corner rod in the fitting using pin and hairpin spring. Ensure that the corner rod is bent upwards towards the roof ridge.

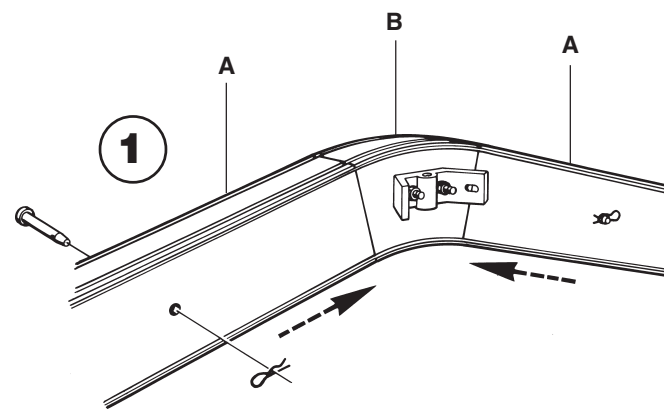

1. Join the main beams (A) to the ridge joint (B).

NOTE:

Turn the ridge joint at the tent end so that the mounted connection stay fitting is facing towards the tent interior.

Insert the lock-pins and secure with the hairpin springs.

NOTE:

Ensure that the tracks for the tarpaulin piping are not damaged at the ends.

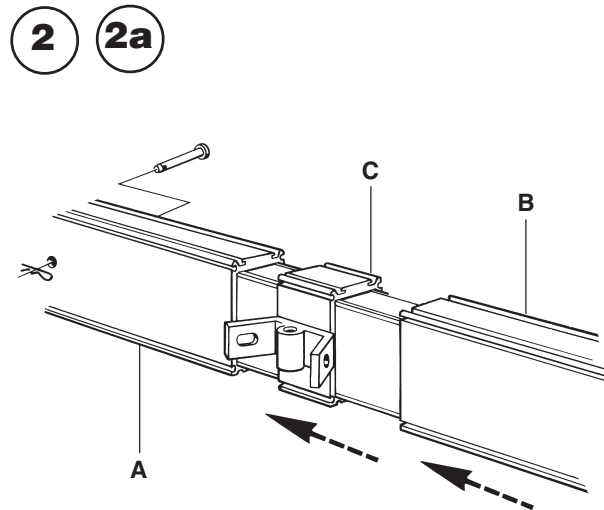

Extend the rafters to the desired length by joining the main beams.

2. Push the straight joint (C) into the main beam (A) and fit lock-pin and hairpin spring.

Push on the main beam (B) and fit lock-pin and hairpin spring.

NOTE:

When Gibson is used on scaffolding, special prerequisites and restrictions must be observed. See page 12.

Frame width (m)	Total Straight joints/frame	Roof beam (combination of 3, 4 and 5 m)	
		Roof brace → Ridge	Ridge → Roof brace
10	-	5 m	5 m
12	1 + 1	3 m + 3 m	3 m + 3 m
14	1 + 1	4 m + 3 m	3 m + 4 m
16	1 + 1	4 m + 4 m	4 m + 4 m
18	1 + 1	5 m + 4 m	4 m + 5 m
20	1 + 1	5 m + 5 m	5 m + 5 m
22	2 + 2	5 m + 3 m + 3 m	3 m + 3 m + 5 m

NOTE:

See the span analysis for permitted widths and side heights.

For tents, span analysis BKR 99 applies.

For weather shelters, the span analysis applies in accordance with the snow analysis.



Always use protective headwear when erecting or striking the tent/ weather shelter.

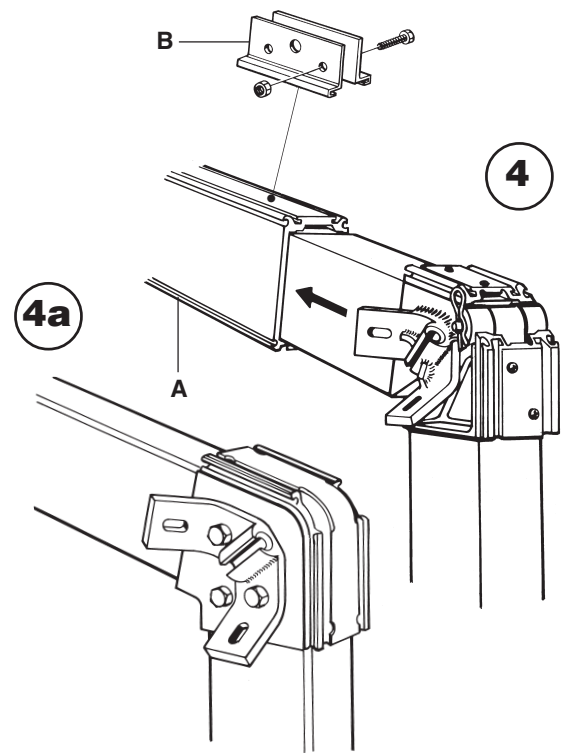

4. Push the articulated or fixed roof brace into the rafter's main beam (A) and secure it with lock-pin and hairpin spring.

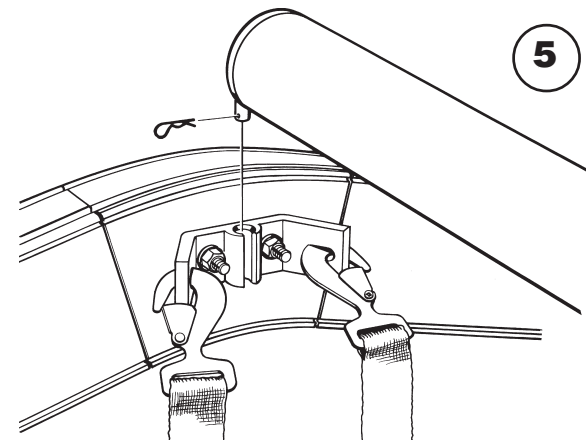

5. Raise the rafters (connection stay fittings turned towards one another) and mount the connection stays. Secure with hairpin springs (does not apply to connection stay at roof brace). Begin at the ridge joint.

Connect the tensioning straps at all connection stay fittings.

Turn the tensioning straps towards the tent interior.

NOTE:

Ensure that the tensioning straps in the roof sections are tensioned and that the frame is squared by performing cross measurements.

Mount the lift fitting (B, figure 4) on the main beam. Position in accordance with the table on page 12.

NOTE!
Tensioning straps shall be mounted as follows:

Section assembly

Mount tensioning straps in all yokes on the roof, end and sides.

Module assembly

Mount tensioning straps in both of the extreme end modules and in every tenth section in all yokes on the roof and sides.

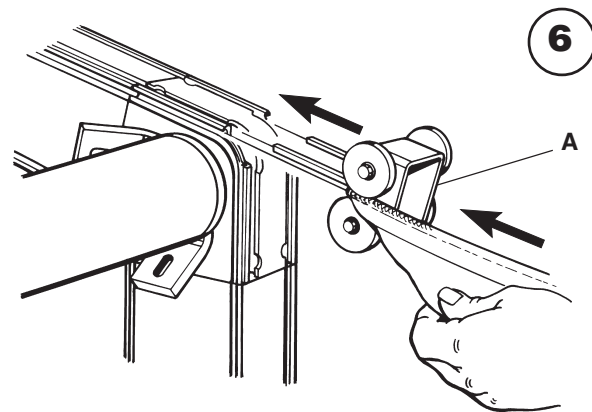

Attaching the Tarpaulin

To facilitate the attachment of the roof tarpaulin, the tarpaulin should be pulled into place before the frame is lifted onto the frame supports.

6. Begin by attaching the roof tarpaulin at the roof brace on one side.

Attachment is facilitated if the assembly tool (A) is pushed into the piping tracks. Next, insert the tarpaulin between the rollers as shown in the figure and pull it over the roof ridge and down to the opposite side's roof brace. Ensure that the tarpaulin is evenly distributed over the roof ridge. In cases where sectionalized tarpaulin is used, the joint shall be at the ridge with ridge joint profile.

Mounting of Frame Supports

A. Fixed Roof Brace

Lift the roof section using a crane and the provided lift sling (see table on page 12).

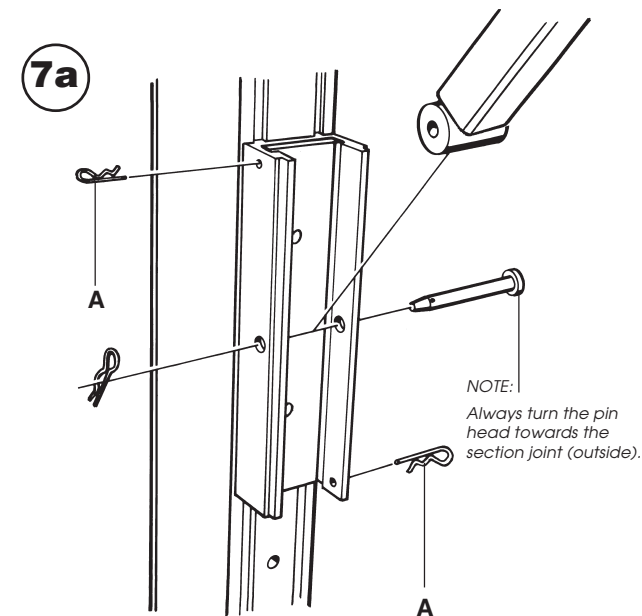

7. Push in the corner rod fitting (travel carrier) into the frame support's main beam. Ensure that the studs on the fitting enter the holes in the beam. Secure the travel carrier with the hairpin springs (A).
Mount the desired frame support in accordance with point 8.
Mount the frame support on the roof brace and secure with pin and hairpin spring.
Mount the corner rod on the fitting using locking pin and hairpin spring.
Now remove the hairpin springs (A).

Mount the lower connection stay (secure with hairpin spring) and connect the tensioning straps. See figure 15 C.

Check that the frame is square by taking cross-measurements.

Anchor the frame with ground anchors or ground spikes.

B. Articulated Roof Brace

7. Fold out the roof brace articulation and mount the frame support so that the desired height is attained. Push the corner rod fitting (travel carrier) into the frame support's main beam. Ensure that the studs on the fitting enter the holes in the beam. Secure the travel carrier with hairpin springs (A).

Push the frame support into place and secure with lock-pin and hairpin spring.

Mount the desired frame support (see point 8).

Mount the connection stay (secure with hairpin springs).

Mount the wind brace (see point 15C).

Mount the side tarpaulin (see point 14).

Mount the tensioning components for roof and side tarpaulins (see points 13 and 16) but do not tension the tarpaulins.

Lift up the frame using a crane and sling (see table on page 12) until the rods retract.

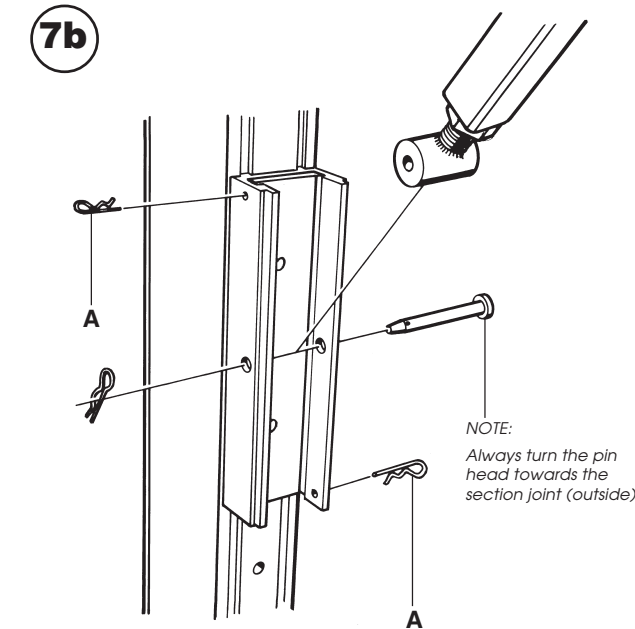

Mount the corner rod on the fitting (travel carrier) using locking pin and hairpin spring.

Now remove the hairpin springs (A).

In regards to calculation of the corner rod's length, see page 13.

Check that the frame is square by taking cross-measurements.

Anchor the frame with the ground anchors or ground spikes.

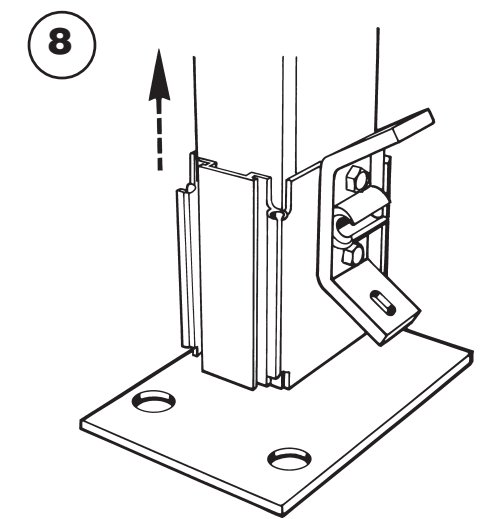

Mounting of Frame Braces

The frame bows can be equipped with either fixed or articulated frame braces. Wheels may also be fitted to the frame braces to enable the tent to be moved along rails.

8. Mount the fixed frame brace so that the broad section of the support plate faces towards the tent interior. Secure the frame brace with locking pin and hairpin spring.

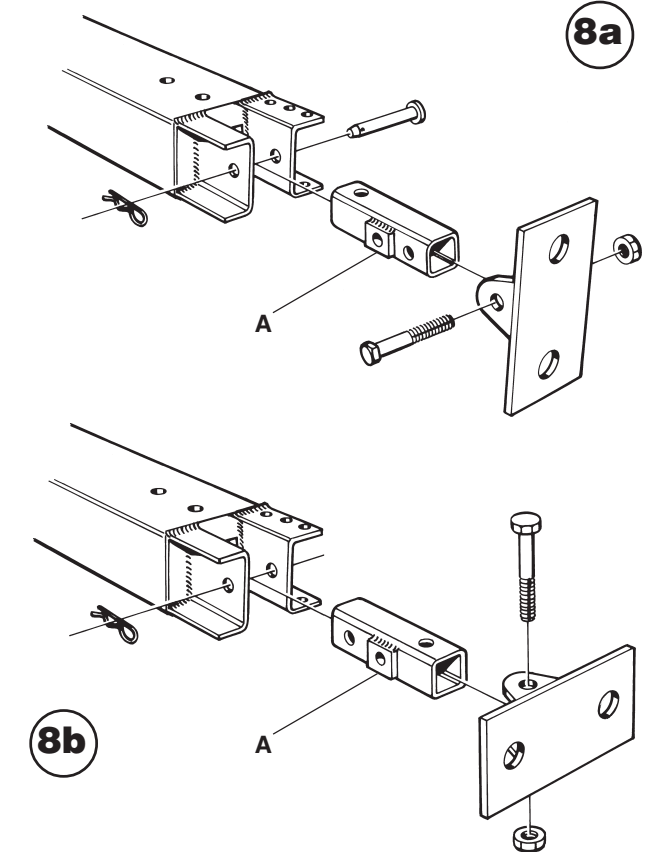

The articulated frame brace can be mounted in two different ways: either so that the support plate is articulated across the width of the tent (8a) or along the length of the tent (8b).

Note how the connection stay (A) is turned in both cases.

Mount the connection stay and secure it with a hairpin spring.

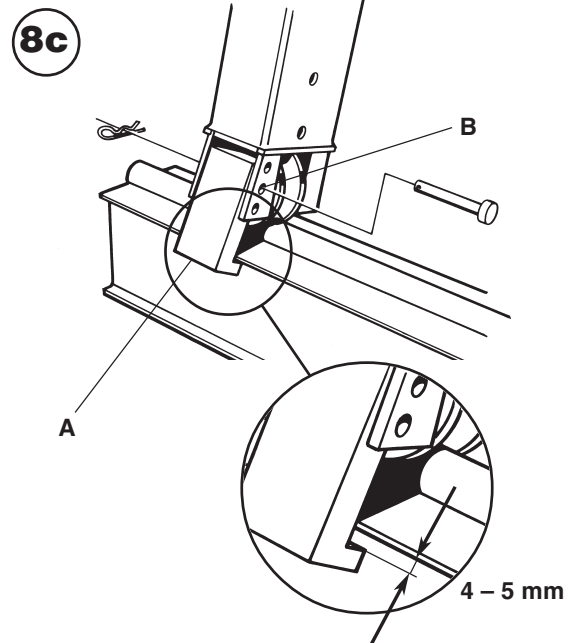

The wheeled-frame brace is used to enable the tent to be moved along a travel beam.
Depending on the frame brace's angle, the retainer (A) can be placed in one of 3 holes (B).
Check that the distance between the retainer and the travel beam is approximately 4-5 mm.

Travel Beam

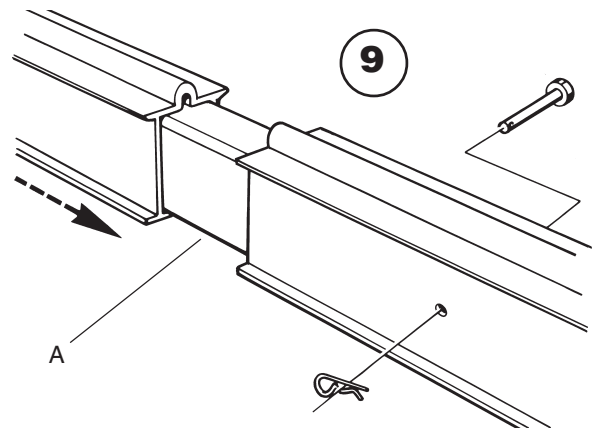

9. The travel beam's length can be varied by joining several beam lengths using joint sections (A).
Secure with locking pin and hairpin spring.

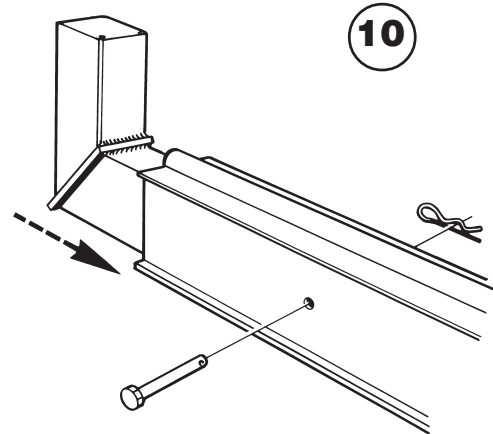

10. Mount an end-stop in each end of the travel beam.
Secure with locking pin and hairpin spring.

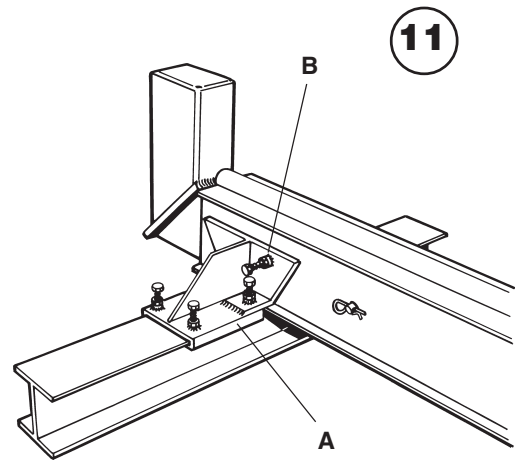

It is of the utmost importance that the travel beams are parallel.

11. Place an HEA beam at the extreme end of the travel beam and a beam at each joint for widths of up to 16 m. For larger widths, c/c = 2.5 m applies.
Ensure that the HEA beams rest on a stable surface and that they are properly anchored with four Burton connectors per HEA beam.
Measure and adjust the distance between the travel beams and secure them using bearing supports (A).

NOTE:

Be sure to secure the travel beam using the screw (B).
Be sure to secure the end supports with tensioning straps to the travel beams.

Tensioning the Roof Tarpaulin

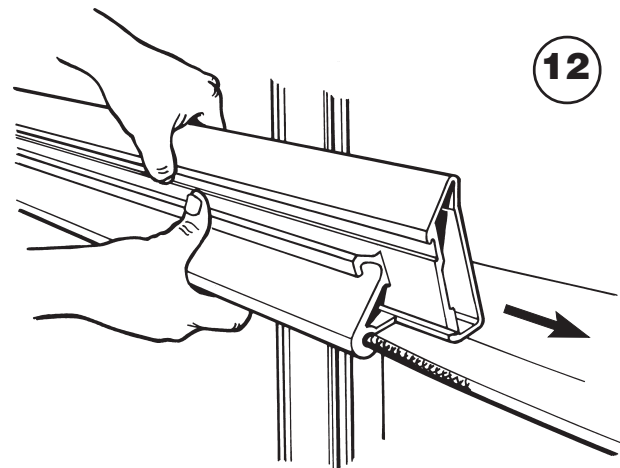

12. Insert the roof tarpaulin's piping into the tarpaulin tensioner's track as shown in the figure.

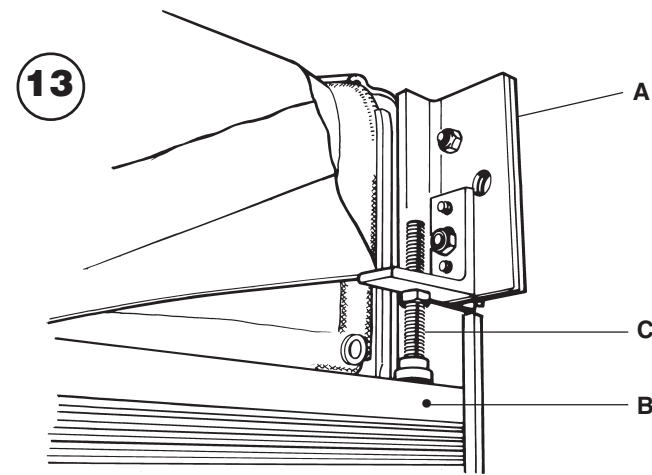

Ensure that the roof tarpaulin is evenly distributed over the roof ridge.

13. Secure a tensioning assembly (A) at the same height in each roof brace corner above the roof tarpaulin's tensioning track (B).
Ensure that the tensioning screw (C) is threaded as far in as possible to enable maximum tensioning of the roof tarpaulin.
Tension the roof tarpaulin by turning the tensioning screw (C) using a hand tool or a drill motor.
Cross-tension the two screws on each tensioning track.

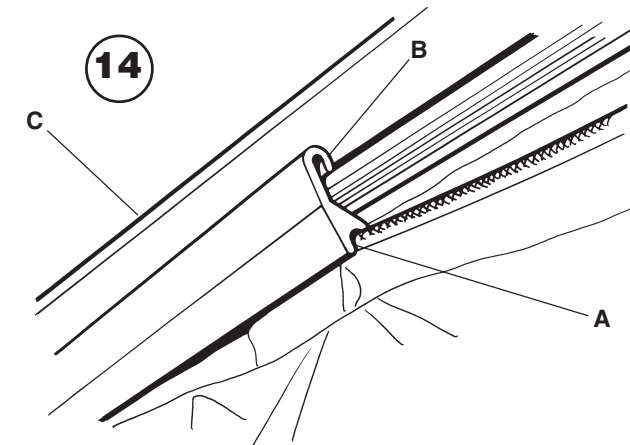

Attaching the Wall Tarpaulin

14. Insert the wall tarpaulin in the frame support's piping track. Begin from beneath and pull the tarpaulin upwards towards the roof brace.
Thereafter, insert the tarpaulin's piping into the fastener profile's piping track (A) on the inside of the tent.
Next, catch the fastener profile (B) onto the roof tarpaulin's tensioning track (C).

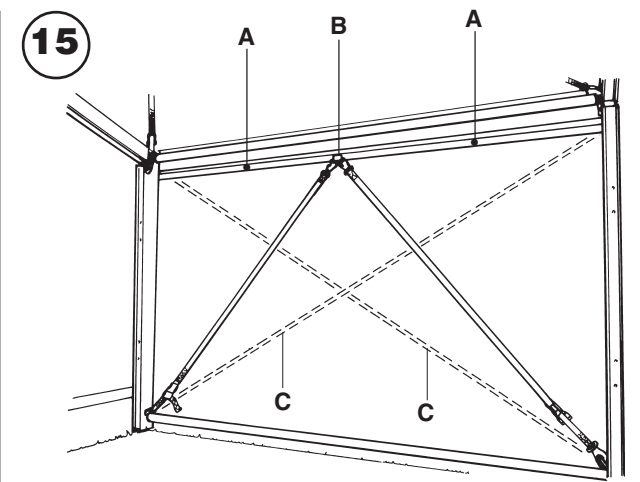

15. During the winter season and for large span widths, joint fitting (B) is mounted between the fastener profiles (A).
Attach two tensioning straps to the yoke on the joint fitting and at each frame support.

Tighten the tensioning straps firmly to hinder wet snow, for example, from bending the fastener profile upwards.

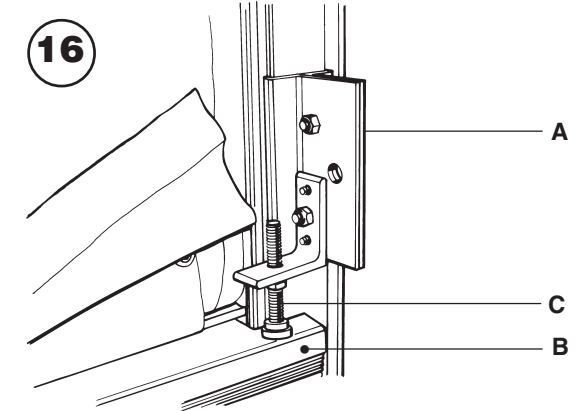

Tensioning of Wall Tarpaulin

16. Secure a tensioning assembly (A) at the same height at each frame support above the wall tarpaulin's tensioning track (B).
Ensure that the tensioning screw (C) is threaded in as far as possible to enable maximum tensioning of the wall tarpaulin.
Tension the wall tarpaulin by turning the tensioning screw (C) using hand tools or a drill motor.
Cross-tension the two screws until the desired tarpaulin tension is attained.

17

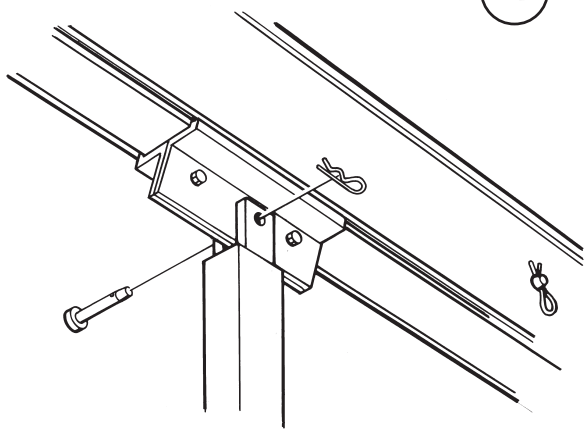

Mounting the End Supports

17. Mount the end support on the lift fitting using locking pin and hairpin spring.

NOTE:

It is important that the locking pin head is turned outwards towards the end tarpaulin to avoid wear damages.

Also make sure that the end support is vertical and that it is correctly anchored to the ground.

Attaching the End Tarpaulin

The two-piece end tarpaulin is mounted by beginning at the roof brace and first pulling one half of the tarpaulin up to the roof ridge in the piping track in the frame.

Thereafter, mount the remaining piece of the end tarpaulin by also beginning at the roof brace and pulling the tarpaulin downwards in the piping track in the frame support.

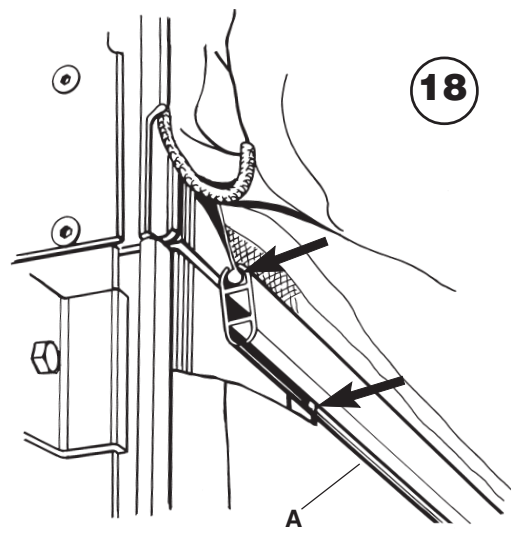

18

The four-piece end tarpaulin is mounted as follows:

First pull one end extension (GF) from the roof brace up towards the roof ridge in the piping track in the frame.

Next, pull the other end extension (GF) in the same way. Secure the two tarpaulins to one another.

Pull the end tarpaulin (G10) into place. Begin with the roof brace and pull the tarpaulin in the piping track until it meets the end extension (GF). Next, mount the remaining piece of tarpaulin by pulling it into the piping track in the frame support. Secure the end tarpaulin (G10) to the end extension (GF).

Tarpaulin Designations

End tarpaulin: G10 x h, left, right

End extension: GF width x height, left, right

Wall tarpaulin: V x height

Roof tarpaulin: T x tent width

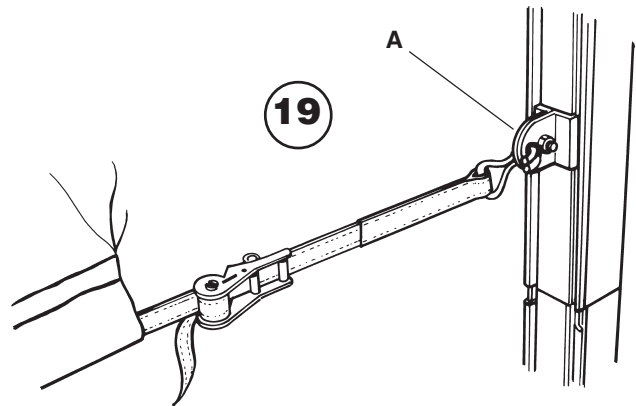

19

19. Mount the universal fitting (A) on the end bows even with the tensioning strap yokes on the end tarpaulin pieces.

Insert the tensioning straps in the yokes and secure the straps in the universal fittings. Tension the straps firmly to prevent the end tarpaulin from rippling in windy weather.

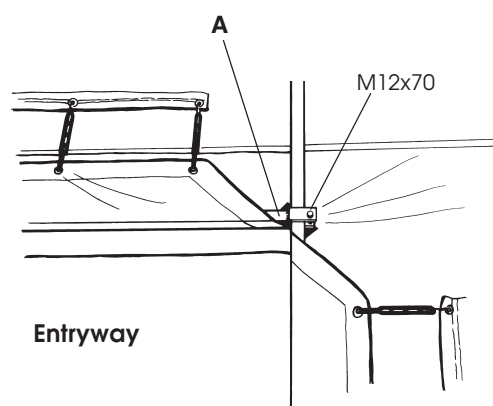

20

20. If the end has an entryway, the handrail (A) is mounted at the correct height on the end brace. Secure it with M12 x 70 screw.

Thereafter, tension the end tarpaulin around the entryway using rubber straps.

Assembly of Entryway Leaves with Tarpaulin

1. Place the tarpaulin on an even surface so that the reinforcement (A) around the U-shaped fitting for the lock faces upwards.

2. Position the frame components in place over the tarpaulin. The frame should be centred, 110 mm inside the tarpaulin's outer edge, all the way around.

NOTE:

The U-shaped fitting for the padlock shall pass through the reinforcement on the tarpaulin (A).

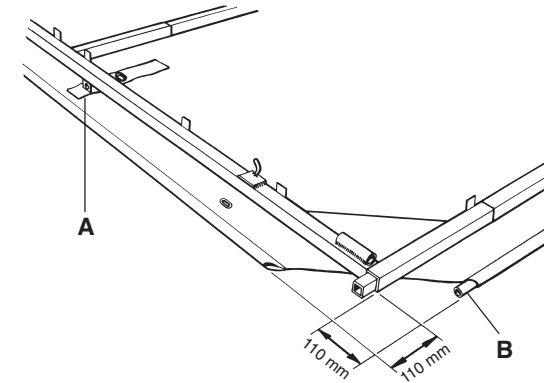

3. Insert the hem tubes (B) into the hems.

4. Cut holes in the tarpaulin directly over the bend plates and then push the tarpaulin over the plates (C). With edges first!

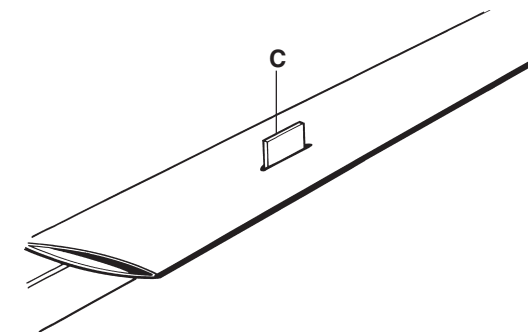

5. Bend down the bend plates with pliers so that the tarpaulin is tensioned. Now use a hammer to fully bend down the plates.

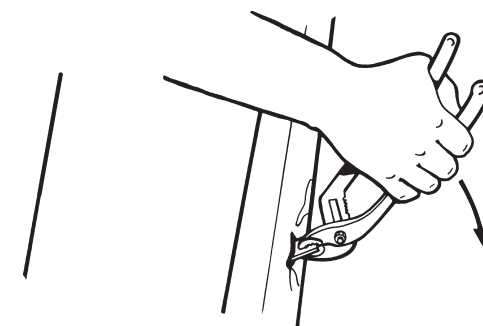

6. Cut holes in the tarpaulin directly over the holes for the runner assemblies. Screw the assemblies in place all the way against the entryway leaf frames to permit height adjustment of the entryway when it is in place.

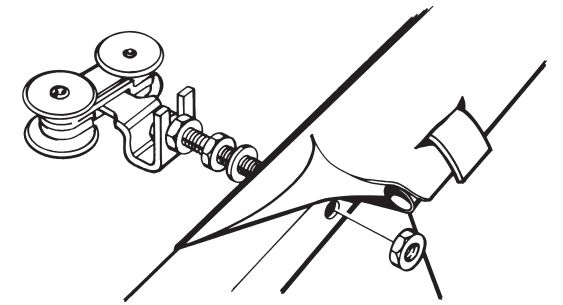

7. Position the runner tracks in place over the runner assemblies. Mount the end stops in each end of the runner track.

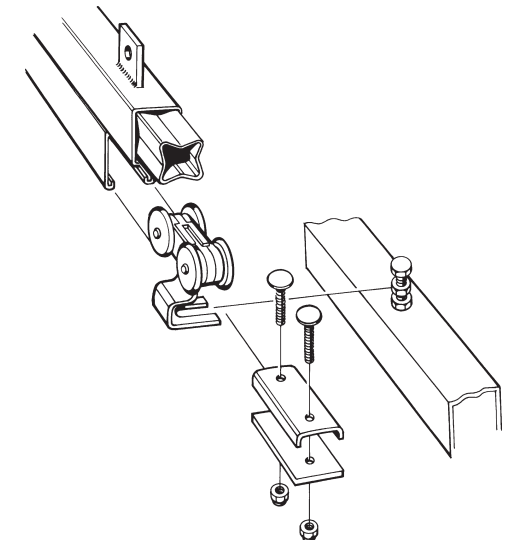

8. Place a wooden block under the entryway that corresponds to the entryway's height over the ground. The support roller on the end brace shall be even with the side of the lower steel frame of the entryway.

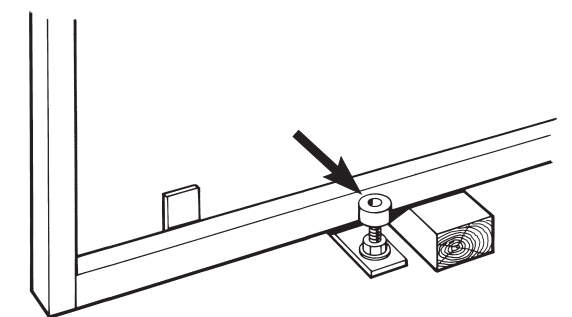

Lift up the entryway leaves (one at a time) and support them on the wooden block.

9. Screw the runner tracks in place on the end brace using the U-fittings (M12 x 70).

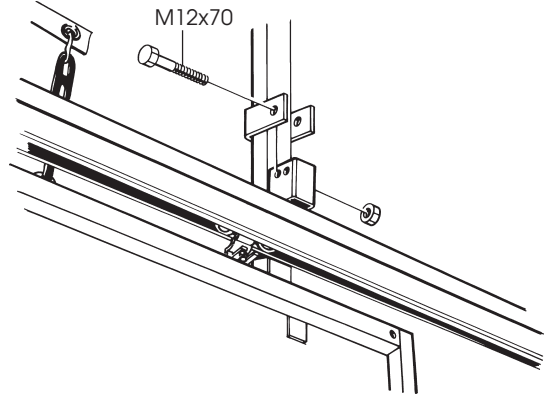

10. Secure the runner track horizontally along the height axis using the stay wires (A). Secure the universal fitting (B) at the roof ridge using the shackle and screw M8 x 40.

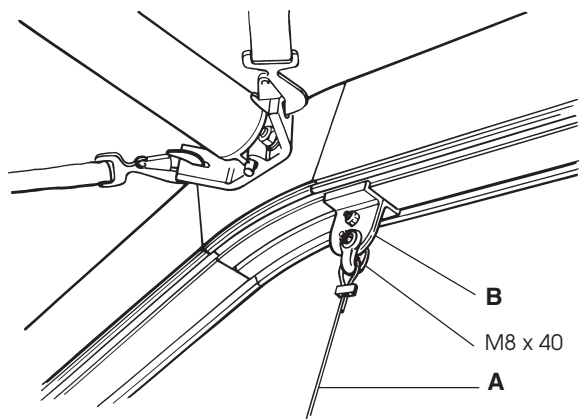

11. Secure the stay wire's turnbuckle (A) at the handrail using screw M8 x 40.

Next, adjust the two entryway leaves along the height axis using the adjuster screw (B) on the runner assembly so that the guide pin on the entryway leaf's frame can enter the hole.

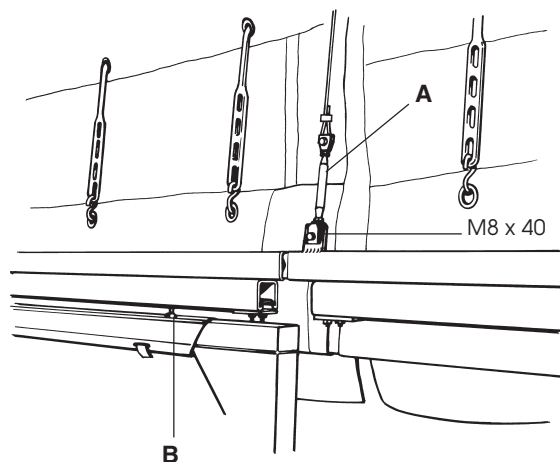

Hit down the tube for the locking pin centred on the guide on the door leaf.

Lift Points for 5 m Sections

Support height 3 m

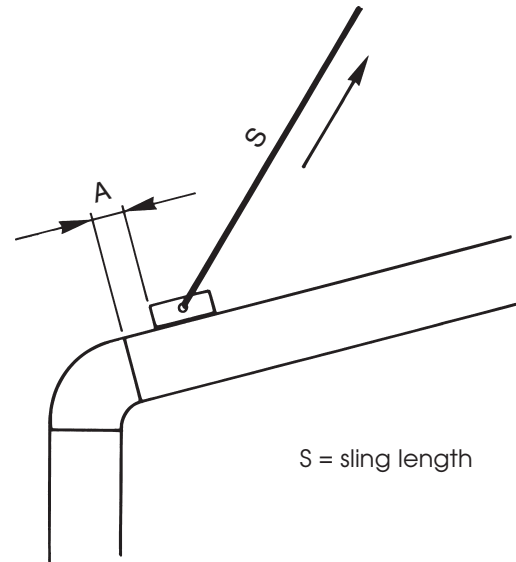

Frame width (m)	S (m)	A (mm)
10	7,0	15
12	8,4	15
14	9,7	15
16	10,9	15
18	12,1	15
20	13,2	15
22	14,1	195

Using Gibson on Scaffolding

To use Gibson on scaffolding, certain prerequisites and conditions must be fulfilled. This applies to, among other things, basic value of wind load ($q_k \leq 0,9 \text{ kPa}$) and the building's capacity to withstand horizontal forces.

Because of this, always contact Jonsereds for advice and tips in regard to these matters. Phone: +46 (0)36 - 30 57 80.

Note the following:

An engineer shall always be engaged to check that the scaffolding has sufficient bearing capacity and to determine the scaffoldings anchorage to the building.

Restrictions on snow volumes on the roof must be unconditionally observed. "Service required" entails that workplace personnel may need to be called out on weekends to remove snow if heating has not been arranged. For heating to work properly in this respect, uninsulated single-ply tarpaulin must be used.

Calculation of Corner Rod Length

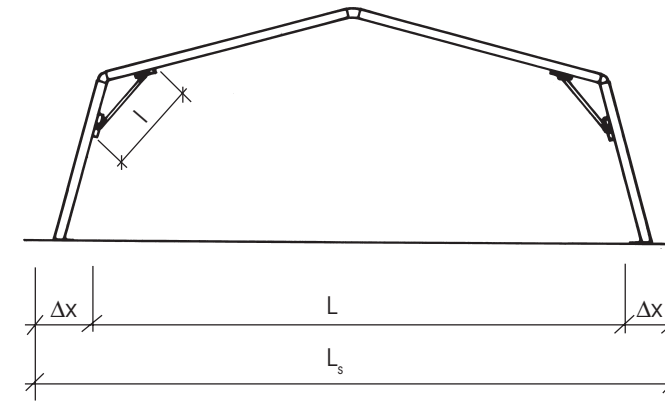

L = Span width for straight supports (c/c travel beam)
 l = Corner rod length (c/c pins) (can be max. 1410 mm)
 L_s = Span width for angled supports (c/c travel beam)
 Δx = Horizontal angled placement of supports (max. 1 m)

Frame width (m)	L (m)	L_s max (m)
10	9,858	11,858
12	11,954	13,954
14	13,838	15,838
16	15,721	17,721
18	17,605	19,605
20	19,489	21,489
22	21,585	23,585

Formula for calculation of length

For support height 3 m: $l = 202 \times \Delta x + 1210$ (mm)
 For support height 4 m: $l = 157 \times \Delta x + 1210$ (mm)
 where Δx = angled placement in meters

Calculation example

Example 1:

Gibson with frame width 16 m and support height 3 m shall be mounted on travel beams c/c 17.35 m.

Solution:

Frame width 16 m in accordance with table results in $L = 15,721$ m.

$L_s = 17,35$ m

Consequently, $\Delta x = (L_s - L)/2 = (17,35 - 15,721)/2 = 0,815$ m.

Finally, the length of the corner rod's length is attained.

$l = 202 \times 0,815 + 1210 = 165 + 1210 = 1375$ mm.

Example 2:

Gibson with frame width 20 m and support height 4 m shall be mounted on travel beams c/c 20.80 m.

Solution:

Frame width 20 m in accordance with table results in $L = 19,489$ m.

$L_s = 20,80$ m

Consequently, $\Delta x = (L_s - L)/2 = (20,80 - 19,489)/2 = 0,656$ m.

Finally, the length of the corner rod's length is attained.

$l = 157 \times 0,656 + 1210 = 103 + 1210 = 1313$ mm.

Summer Weather Shelter with Articulated Roof Braces

Span width analysis in accordance with BKR 99

Permitted frame widths.

Wind load $q_k \leq 0,9 \text{ kPa}$ (verified with engineer).

q_k = characteristic value of the wind's velocity pressure.
 (wind load basic value).

Permitted frame width	5 m sections						
	Frame width (vertical supports)*						
Supp. h.	10 m	12 m	14 m	16 m	18 m	20 m	22 m
3 m	OK!	OK!	OK!	OK!	OK!	OK!	OK!
4 m	OK!	OK!	OK!	OK!	OK!	OK!	OK!

Permitted frame width	5 m modules						
	Frame width (vertical supports)*						
Supp. h.	10 m	12 m	14 m	16 m	18 m	20 m	22 m
3 m	OK!	OK!	OK!	OK!	OK!	OK!	OK!
4 m							

* Span width can be increased with a maximum of 2 m through **symmetric** angling of supports. See below.

Asymmetric angling of the supports and/or various support heights are not permitted without an engineer's permission.

Special analysis must be performed.

Winter Weather Shelter with Articulated Roof Braces

Span width analysis in accordance with snow load analysis

Permitted frame widths.

Snow load $s_0 = 0,52 \text{ kN/m}^2$ $s_k = 0,8 \cdot s_0$

Wind load $q_k \leq 0,9 \text{ kPa}$ (verified with engineer)

s_0 = snow load basic value at ground

s_k = snow load characteristic value at roof

q_k = characteristic value of the wind's velocity pressure
 (wind load basic value)

Permitted frame width	5 m sections						
	Frame width (vertical supports)*						
Supp. h.	10 m	12 m	14 m	16 m	18 m	20 m	22 m
3 m	OK!	OK!	OK!	OK!	OK!	OK!	OK!
4 m	OK!	OK!	OK!	OK!	OK!	OK!	

Permitted frame width	5 m modules						
	Frame width (vertical supports)*						
Supp. h.	10 m	12 m	14 m	16 m	18 m	20 m	22 m
3 m	OK!	OK!	OK!	OK!			
4 m							

* Span width can be increased with a maximum of 2 m through **symmetric** angling of supports. See below.

Asymmetric angling of the supports and/or various support heights are not permitted without an engineer's permission.

Special analysis must be performed.

Above-mentioned snow load entails the following restrictions:

1. Maximum 14 cm snow on roof, but maximum 10 cm of wet snow.
2. Service required.

Winter Tent with Fixed or Articulated Roof Braces and Fixed Corner Rods

Span width analysis in accordance with BKR 99

Permitted snow zones.

Wind load $q_k \leq 0,72$ kPa (verified with engineer)

q_k = characteristic value of the wind velocity pressure (windload basic value)

Snow zone acc. BKR 99	5 m sections/2,5 m modules						
	Frame width (vertical supports)						
Supp. h.	10 m	12 m	14 m	16 m	18 m	20 m	22 m
2 m	3,5	2,5	1,5	1			
3 m*	2,5	2	1,5	1			
4 m*	2,5	1,5	1	1			
5 m	2	1,5	1				

Snow zone acc. BKR 99	5 m modules						
	Frame width (vertical supports)						
Supp. h.	10 m	12 m	14 m	16 m	18 m	20 m	22 m
2 m	1,5	1					
3 m*	1	1					
4 m*	1						
5 m							

* Span width can be increased with a maximum of 2 m through **symmetric** angling of supports. See below.
Asymmetric angling of the supports and/or various support heights are not permitted without an engineer's permission.
Special analysis must be performed.

Summer Tent with Fixed or Articulated Roof Braces and Fixed Corner Rods

Span width analysis in accordance with BKR 99

Permitted frame widths.

Wind load $q_k \leq 0,72$ kPa (verified with engineer)

q_k = characteristic value of the wind velocity pressure (windload basic value)

Permitted frame width	5 m sections/2,5 m modules						
	Frame width (vertical supports)						
Supp. h.	10 m	12 m	14 m	16 m	18 m	20 m	22 m
2 m	OK!	OK!	OK!	OK!	OK!	OK!	OK!
3 m*	OK!	OK!	OK!	OK!	OK!	OK!	OK!
4 m*	OK!	OK!	OK!	OK!	OK!	OK!	OK!
5 m	OK!	OK!	OK!	OK!	OK!	OK!	OK!

Permitted frame width	5 m modules						
	Frame width (vertical supports)						
Supp. h.	10 m	12 m	14 m	16 m	18 m	20 m	22 m
2 m	OK!	OK!	OK!	OK!	OK!	OK!	OK!
3 m*	OK!	OK!	OK!	OK!	OK!	OK!	OK!
4 m*	OK!	OK!	OK!	OK!	OK!	OK!	OK!
5 m							

* Span width can be increased with a maximum of 2 m through **symmetric** angling of supports. See below.
Asymmetric angling of the supports and/or various support heights are not permitted without an engineer's permission.
Special analysis must be performed.

Dimensions

		10 m	12 m	14 m	16 m	18 m	20 m	22 m
	A	9665	11760	13645	15529	17412	19296	21392
	B	10048	12144	14027	15911	17794	19678	21774
Sup. 2 m	C	1380	1380	1380	1380	1380	1380	1380
	D	2325	2325	2325	2325	2325	2325	2325
	E	3665	3945	4196	4449	4701	4953	5234
Sup. 3 m	C	2355	2355	2355	2355	2355	2355	2355
	D	3300	3300	3300	3300	3300	3300	3300
	E	4640	4920	5171	5424	5676	5928	6209
Sup. 4 m	C	3330	3330	3330	3330	3330	3330	3330
	D	4275	4275	4275	4275	4275	4275	4275
	E	5615	5895	6146	6399	6651	6903	7184
Sup. 5 m	C	4305	4305	4305	4305	4305	4305	4305
	D	5250	5250	5250	5250	5250	5250	5250
	E	6590	6870	7121	7374	7626	7878	8159

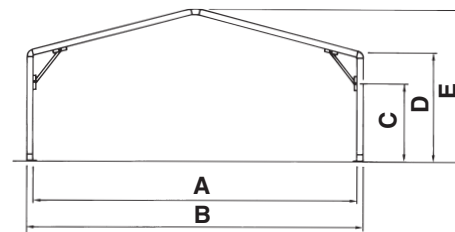

Component Designations

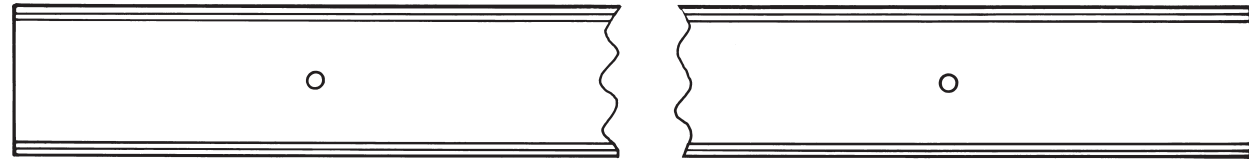

Main beam

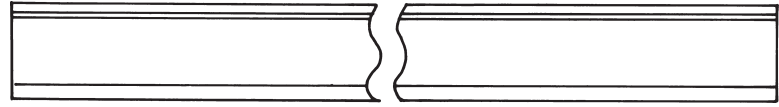

Tarpaulin tensioner



Fastener profile, long



Joint strip, roof tarpaulin



Joint strip, party end tarpaulin

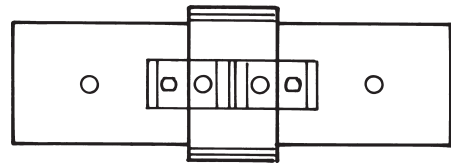

Straight joint

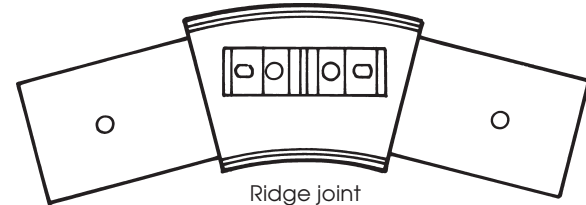

Ridge joint

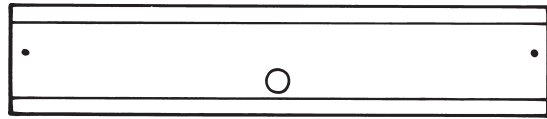

Travel carrier



Corner rod, adjustable

Corner rod, fixed



Connection stay



Stay wire for entryway track



Tensioning strap, end tarpaulin



Tensioning strap, wind brace

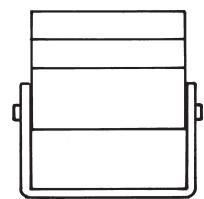

Fastener profile, short

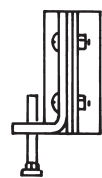

Tarpaulin tensioner
Section assembly

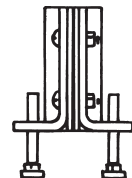

Tarpaulin tensioner
Module assembly

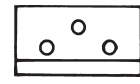

Lift fitting



Universal fitting

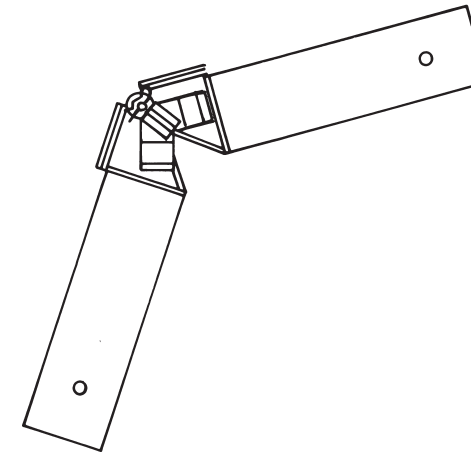

Articulated roof brace with
connection stay fitting
(left, right, double)

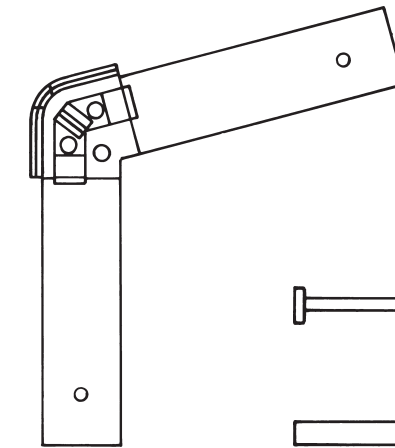

Fixed roof brace with
connection stay fitting
(left, right, double)



Hairpin spring

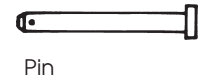

Pin



Ground spike

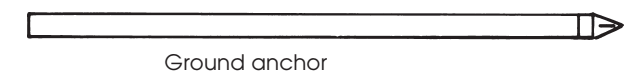

Ground anchor

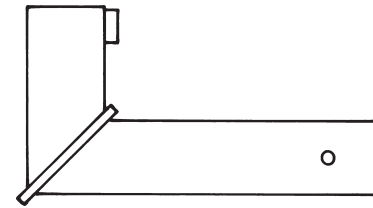

End-stop, travel beam

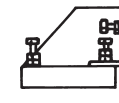

Bearing support, travel beam



Travel beam

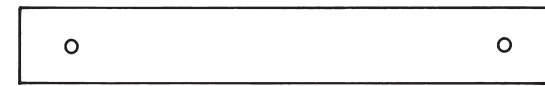

Joint section, travel beam

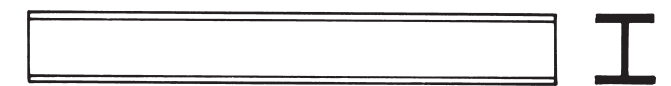

HEA-beam 120

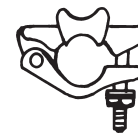

Burton
connector

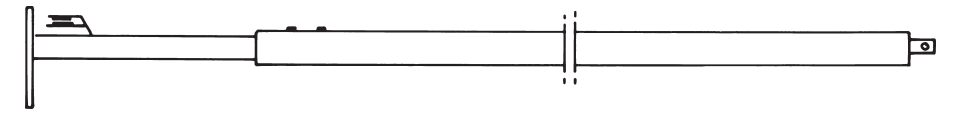

End support

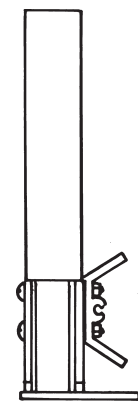

Fixed brace
Section assembly

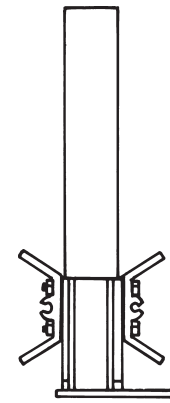

Fixed brace
Module assembly

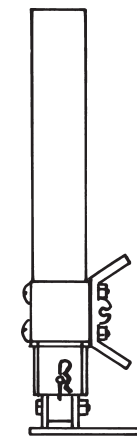

Articulated brace
Section assembly

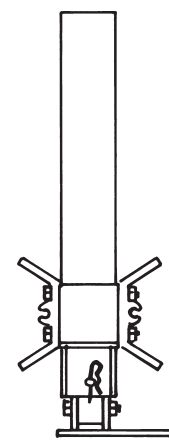

Articulated brace
Module assembly

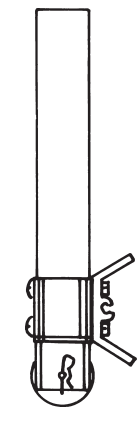

Wheel box
Section assembly

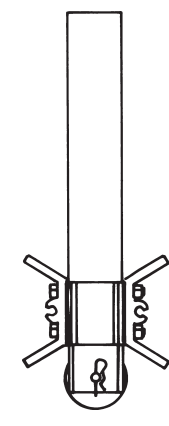

Wheel box
Module assembly

**WARNING**

Make sure that the tent/
weather shelter is properly
anchored.



Always use protective
headwear when erecting or
striking the tent/weather
shelter.

Tips and Advice to Consider

1. Read through the assembly instructions before beginning assembly.
2. Check that the delivery is in agreement with the shipping list.
3. If the surface on which the tent/weather shelter will be assembled tilts, assembly shall begin at the highest point.
The maximum permitted tilt is 1.2%.
4. **Make sure that anchorage is sufficient.**
Gravel surfaces require extra anchorage in addition to the provided ground anchors/ground spikes.
Contact Jonsereds for advice.
5. Never leave a frame without securing tensioning straps and ground anchors/ground spikes in accordance with the instructions.
6. When returning, ensure that the tarpaulin is manageable and the markings are clearly visible.

General Care Instructions

Roof, Side and End Tarpaulin Sections

1. Tarpaulin Tensioning

It is important that the tarpaulins are properly tensioned so that they cannot ripple. There is otherwise considerable risk that the tarpaulins will become worn and/or torn against the frame.

Check the tarpaulin tension at least once each year. Tension the tarpaulin as needed. This considerably lengthens the tarpaulin's service life.

2. Tarpaulin Cleaning

Clean with warm water, preferably at high pressure. Use mild cleaning agent.

Solvents can be used in concentrated form on more difficult spots.

For severe soiling, methylated spirits can be used with extreme caution so that the softener in the tarpaulin is not damaged.

3. Wear and Tear

Leased products: Repaired by Jonsereds.

Purchased products: The tarpaulin is repaired using a hot-air gun or with special glue available from Jonsereds. Place a patch of PVC tarpaulin over the damaged area. Secure it with glue or heat from the hot-air gun. For larger damages, contact Jonsereds.

4. Snow Removal

During snow removal, snow may not be ploughed or shovelled against the tarpaulin.

If snow pockets form on the tarpaulin, they shall be immediately removed. The tarpaulin can otherwise be permanently deformed.

Snow pockets on the roof are formed when the tarpaulin is poorly tensioned.

Tension the tarpaulin hard.

Frame

1. Tensioning Straps

Check that the tensioning straps are properly tensioned.

The tensioning straps shall be cleaned, marked and checked to ensure that they are free from damage before returning to us.

2. Ground Anchors

Ensure that the ground anchors/ground spikes are properly secured and in contact with the end support.

If the tent/weather shelter is mounted on tracks, ensure that the tracks are properly anchored.

3. Handle the Entryways with Care

Check that the entryway assemblies are straight and function properly, and that the wheels roll freely. Check that the wheel assemblies travel freely along the entryway tracks.

Lubricate as needed.

4. Miscellaneous

Check that there are no cracks along the welded joints and that the frame components with "break profiles" (profiles in which the tarpaulin's piping are drawn) are free from damage.

